

SMART MODULE

Digital Intelligent Power Distribution Solution Provider



Sfere700-TM Sfere700-TS

Distributed multi-channel temperature monitoring module



Distributed design
Scale flexibly
Up to 24 temperature measurements
RS485 communication interface



APPLICATIONS



Low-voltage power distribution system



Temperature monitoring

FUNCTION

| Model | Sfere700-TM | Sfere700-TS |
|--------------------------------|---|---------------------|
| Type | Master module | Slave module |
| Temperature monitoring channel | 6 | 6 |
| RS485 communication interface | 1-way slave station (to external) 1-way master station (to slave module) | 1-way slave station |

DIMENSIONS

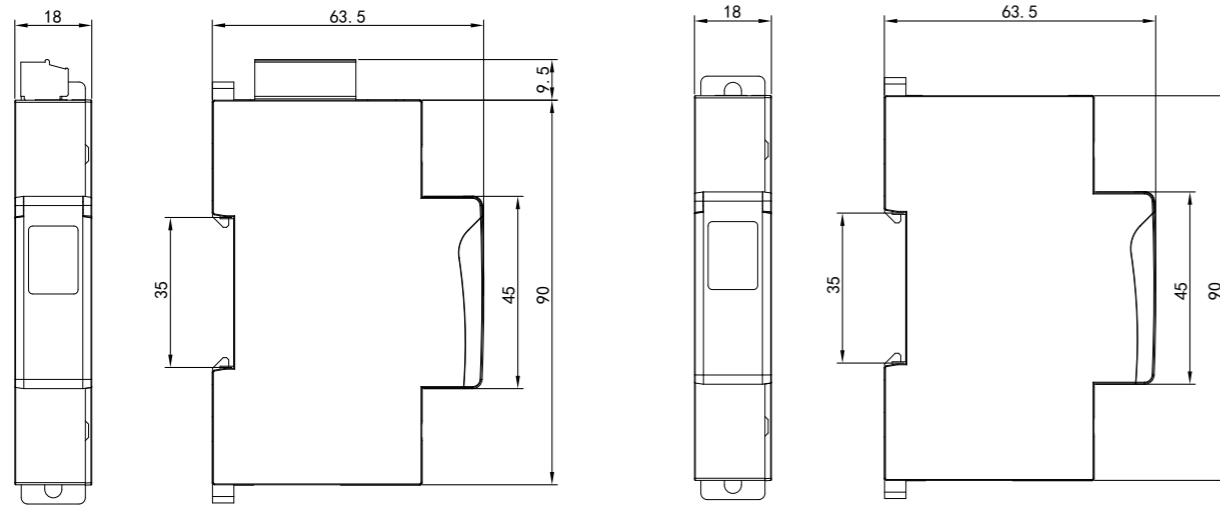

Sfere701-TM

Sfere701-TS

TYPICAL WIRING

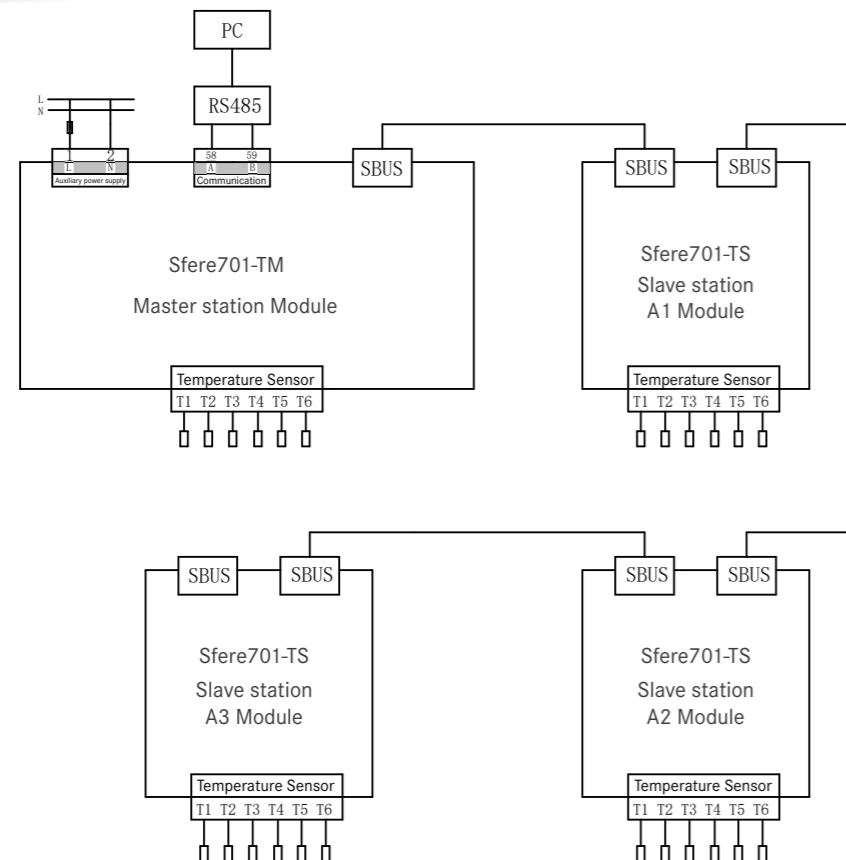

TECHNICAL SPECIFICATION

| Function | Sfere700-TM | Sfere700-TS |
|--|----------------------------|-------------|
| Temperature measurement | | |
| Number | 6 (Single module) | |
| Type | NTC 10k | |
| Accuracy | ±1 °C | |
| Range | -20 ~ 140 °C | |
| Power supply | | |
| Voltage Range | AC/DC 80 ~ 270V, 50/60Hz | SBUS Power |
| Consumption | ≤ 5VA | |
| Communication | | |
| Interface | RS485 | |
| Protocol | Modbus-RTU, 4800-115200bps | |
| Isolation | 4000V AC | |
| Ambient condition | | |
| Operating temperature | -20°C ~ 70°C | |
| Relative humidity | ≤ 95%RH, Non condensing | |
| Altitude | ≤ 2500m | |
| IP Degree | IP20 | |
| Withstand | IEC 61010-1 | |
| EMC | | |
| Electrostatic discharge immunity | IEC 61000-4-2- Level III | |
| Radio frequency electromagnetic field radiation immunity | IEC 61000-4-3- Level III | |
| Electrical fast transient immunity | IEC 61000-4-4- Level III | |
| Impact (surge) immunity | IEC 61000-4-5- Level III | |
| Immunity to conducted interference induced by RF field | IEC 61000-4-6- Level III | |
| Power frequency magnetic field immunity | IEC 61000-4-8- Level III | |
| Immunity to voltage sags and short interruptions | IEC 61000-4-11- Level III | |

Sfere700-DI3

Switching monitoring module



Easy to install
RS485 communication interface
Compact design



APPLICATIONS



Low-voltage power
distribution system



Temperature
monitoring

DIMENSIONS

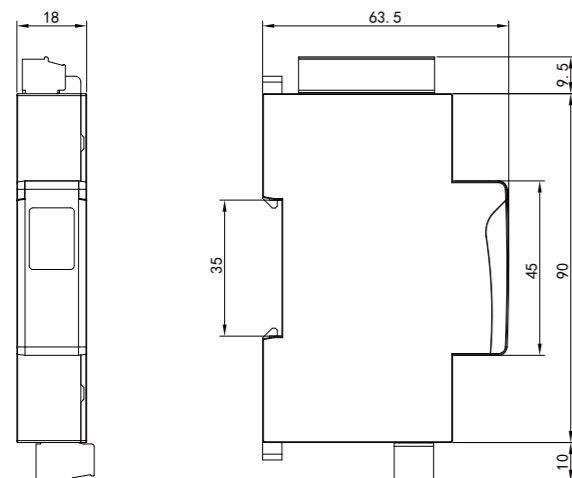

TYPICAL WIRING

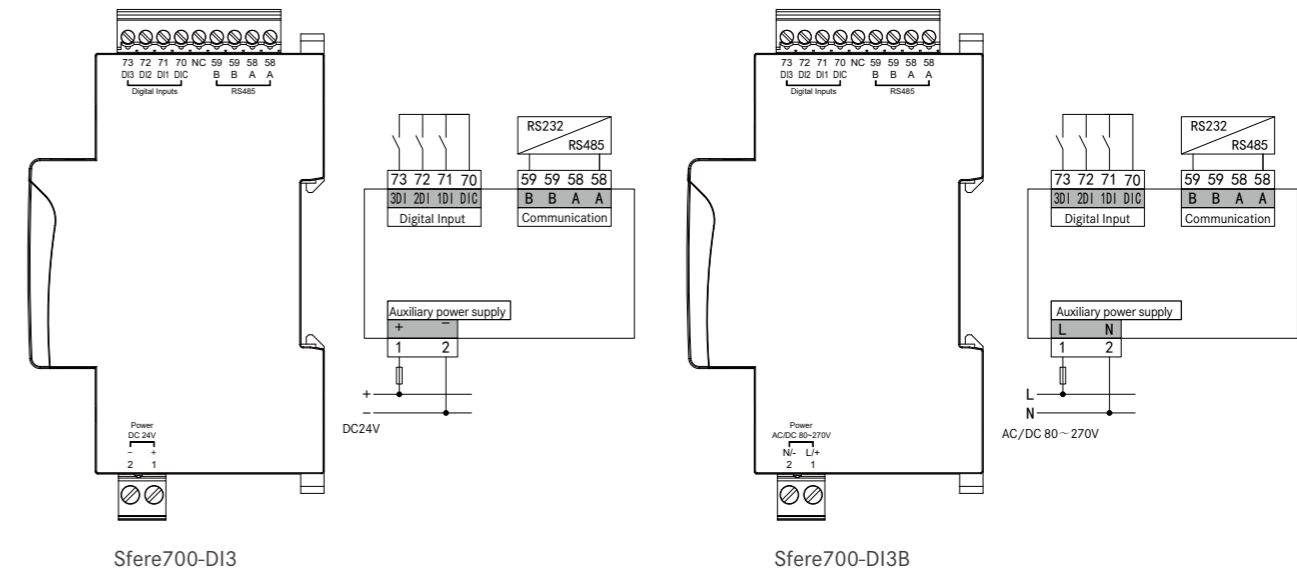

TECHNICAL SPECIFICATION

| Digital input | |
|-----------------------|---|
| Number | 3 |
| Input type | Dry contact |
| Insulation | 2000 V AC |
| Scan time | 10 ms |
| Filter time | 30 ms |
| Communication | |
| Interface | RS485 |
| Protocol | Modbus-RTU, up to 19200bps |
| Insulation | 2000 V AC |
| Power supply | |
| Rated range | Sfere700-DI3: DC24V \pm 20%; Sfere700-DI3B: AC/DC 80 ~ 270V |
| Consumption | \leq 0.5W |
| Ambient condition | |
| Operating temperature | -25°C ~ 70°C |
| Relative humidity | \leq 95%RH |
| Altitude | \leq 2000m |
| IP Degree | IP20 |
| EMC | Better than level III |